

What the logo looks like:

SUPER
CUBE



Super Cube

By:

H I S T O R Y :

Hi, my name is _____ I am 96 years old and I am the founder of my company _____'s Super Cube. I started this company when I was 18 years old, right when I graduated. While you're asking yourself why I have a soccer ball next to my logo is because when I was a young girl I loved playing soccer and it was my dream to become a professional soccer player. Well that was until I was in middle school and my technology and engineering teacher introduced puzzle cubes to us. From that day on I was so intrigued and wanted to have my own puzzle cube company. I still love soccer to this day, but not as much as I love building puzzle cubes!

DESIGN :

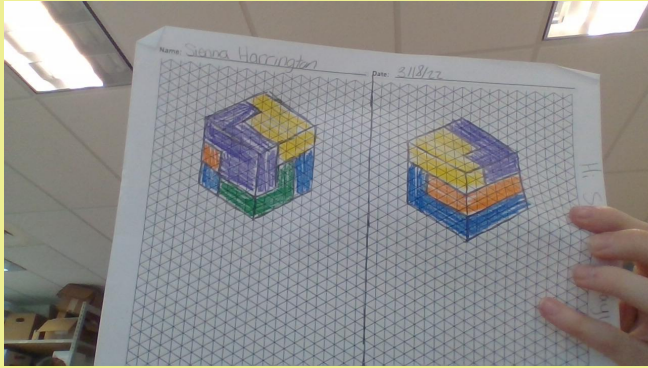

This is the cube drawn out on paper.

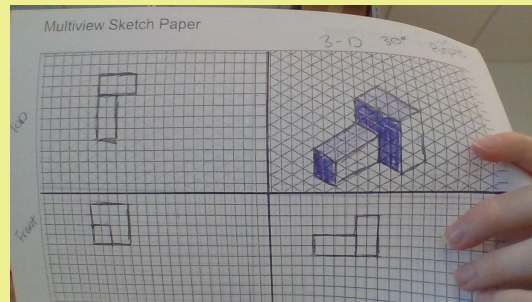
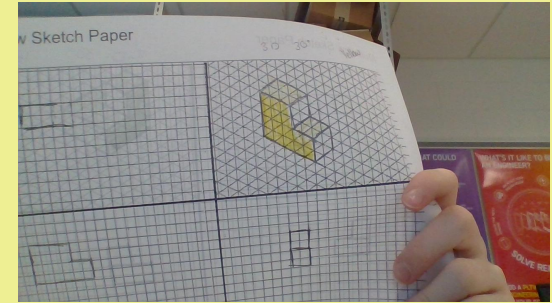
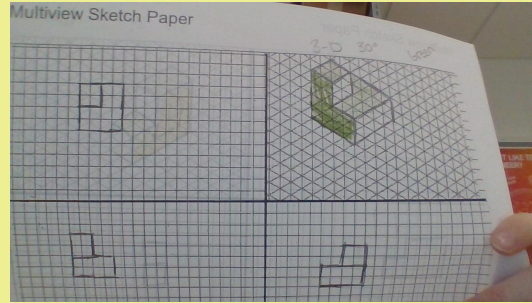
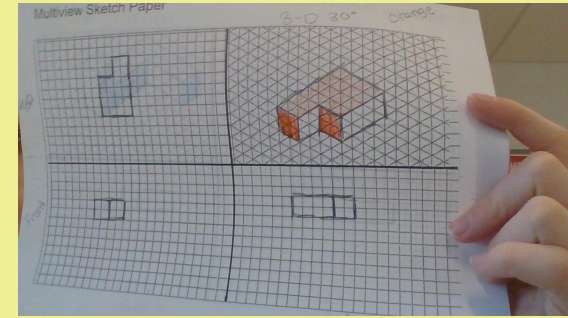
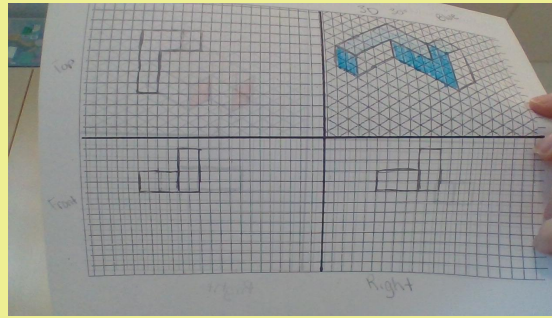

This is each design drawn separately on individual paper.

3-D Views of my cube

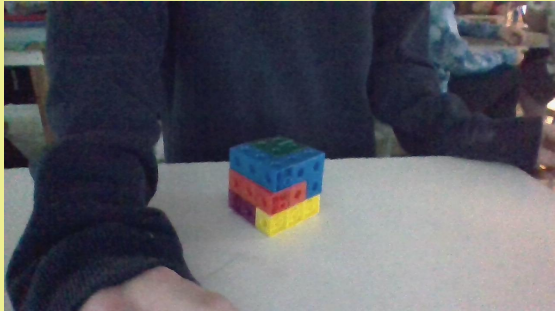
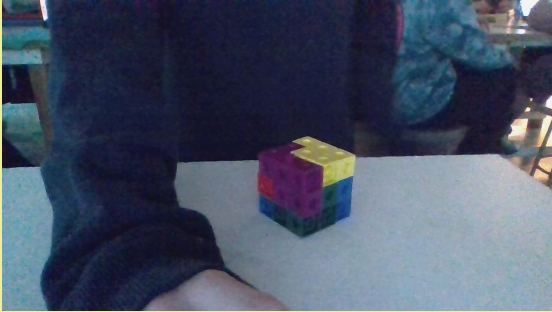

This is the cube fully put together with blocks.

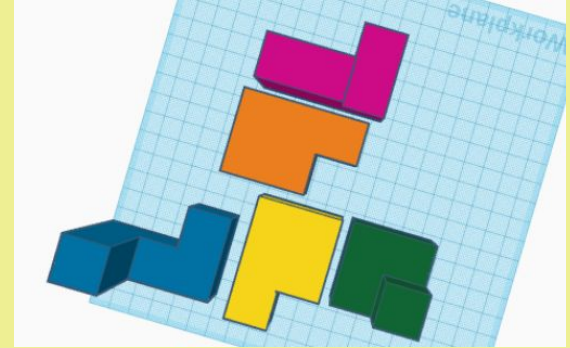

This is what my shapes look like on tinkercad. From the top view.

Raw Materials

- $\frac{3}{4}$ Inch hardwood cubes \$0.07
- Gorilla glue per oz \$0.33
- Pack of paint per oz \$0.38



This is what the blocks look like



This is what the glue looks like



Lastly, this is what the paint looks like.

Production:

Station #1:

Station number one is where the blocks come from first to start the process. It drops the exact amount of blocks needed per shape.

Station #2:

Station two is where the blocks go after being dropped. They go down then right to create a straight line.

Station #3:

Station 3 is when all the blocks are done being lined up, a little door opens.

Station #4:

Station number four is a robot. We call him George. George gets the blocks from the door.

Station #5:

Station number five is that George takes the blocks to a put together machine.

Station #6:

Station number six puts all of the blocks in order accordingly to the shape it is opposed to. This is a mechanical arm.

Station #7:

Station number seven is the gluing station. A mechanical arm puts glue together.

Station #8:

Is when it moves to station number nine.

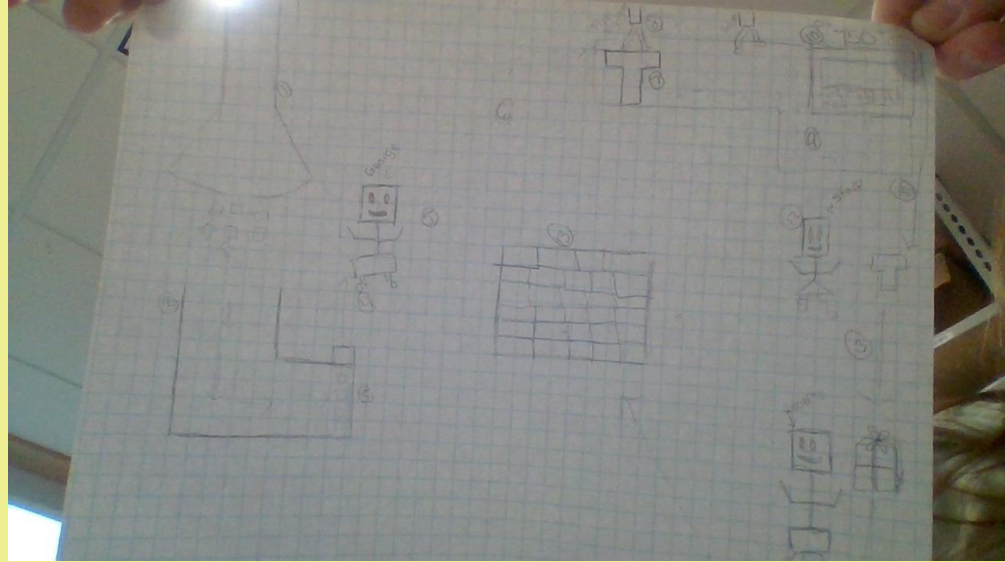

Station #9:

Station nine is where the blocks go through a dryer to dry the glue.

Station #10:

Station ten is when another robot (Steff) goes to get the blocks when they have fully dried.

Station #11:

Is when that Steff brings the cubes over to another robot (Roberto)

Station 12:

Lastly, station 12 is when Roberto packages it and then throws it into the pile of others ready to get shipped out.

Quality Control:

The blocks drop from the tube, the amount of blocks are exact for the shape that's being created. Once the blocks get placed into their correct shapes the gluing machine will glue all of the pieces together to keep them in one whole piece. When the glue is dry and all set a robot paints it to make it look not so plain. The last step is then another robot will throw it against the ground to make sure it is sturdy (which it always is) then wraps it in a box.

Packaging/Shipping

The container it will be packaged in will be a box. FedEx will be the one delivering our awesome cubes to you all!



FedEx
Express

Sales and marketing

The price for each cube will balance out to about \$10, in U.S dollars. Each piece is rounded to around one dollar, but with every piece added up to make a total cube will be \$7. So, I will make around 3-4 dollar profit. Once every month, there will be a sale for our cubes they will be \$4 this only last for one day a month!

Logo:

S U P E R
C U B E

